



DIVA 
FIRE-RATED

Fire resistant automatic sliding door

A safety fire-resistant solution suitable for public places with heavy traffic flow such as retail, health care, leisure.

In compliance with EN 1634-1 and 13501-2 standards.

- \\ INNOVATIVE AND EFFICIENT
- \\ POWERFUL MOTOR
- \\ CLASS EI2-30 DOOR UNIT

PORTALP
Automatic Doors & Building Access Control

Safety and elegance combined with strength and performance.



Fire door can be combined:

- one sliding door (to the right or to the left),
- two sliding door (central opening),
- with or without side screens,
- on a lightweight and fire resistant partition (fire-rated).

Lightweight partition version with transoms.

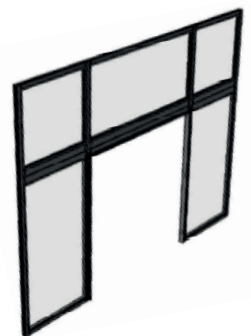

The door unit is installed on a single supporting frame

Integrated fire seals provide efficient fire containment

Reduce fire spread for 30 minutes

Reliable and controlled closure in the event of a fire alarm detection

The door is equipped with counterweight. In the event of a fire, it will mechanically shut down thanks to a counterweight, without needing any electrical source. The door closes at controlled speed, continuously monitoring the counterweight connecting cable.

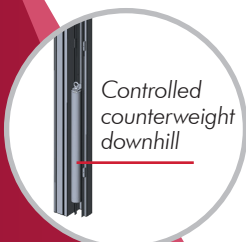

Controlled counterweight downhill

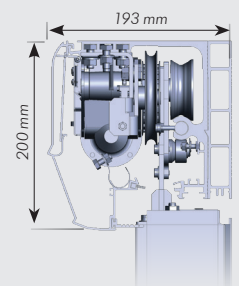

The driving mechanism is protected within a rugged compartment.

Smartphone access control



- Available in your own language
- Intuitive navigation
- Direct mode selection
- User friendly
- Low Energy Bluetooth
- Dedicated app (iOS and Android)



DIVA RS FIRE-RATED FEATURES

Designed to prevent the spread of fire flames

Rugged fire-resistant door panels

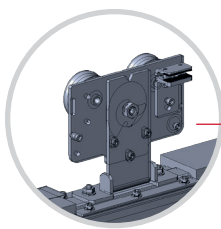

Carriages roller design for heavy-duty doors

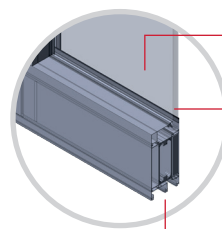

Glazing fixed by clip-in profiles

High fire-resistance performance glazing

In & out guides integrated into the frame

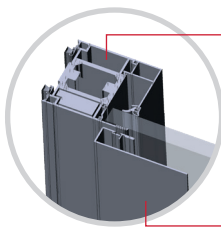

3-chamber profile with thermal struts

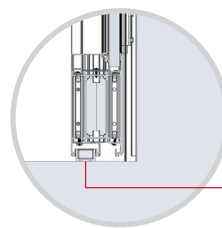

Door panel guide shoe

Steel channel

Wire fire detector alarms



Manual release (option)

Door panels immediately close upon manual emergency activation.

THE SAFETY AND THE RELIABILITY OF AN AUTOMATIC DOOR

Robust and advanced operator



Switch-mode power supply

Independent from supply voltage, parasite filtering, and low consumption.



Brushless Motorization

Long-lasting lifetime, quiet, fluent and safe door panel guidance.



Output extension board

Flexible output module which will fit and customize your devices.



Security / device CAN bus

Easy to wire, constant communication, fault detector.

Safe & Secure Activation



When passing through

Activation & Safety Sensor combining presence detection and closing zone monitoring.

When opening

Secures the door leaves' rollback zone.



SPECIFICATIONS FIRE-RATED DIVA RS



FIRE RESISTANT DOOR UNIT

Installation	Bracket / with or without frame / with or without transom
Installation structure	Lightweight aluminum frame fire resistant partition ⁽¹⁾ or aerated concrete
Glass panels	Aluminum frame and Contraflam® 30 panes (VSGI Saint-Gobain®)
Fire rating	EI2-30
Reinforced header	H 200 x 193 mm
Min/max passing width ⁽²⁾	Single 730 / 1550 mm Double 1270 / 2400 mm
Min/max passing height	1900 / 2500 mm
Max transom height for lightweight partition	500 mm

⁽¹⁾ Subjected to fire inspection. ⁽²⁾ Limit with counterweight on passage width < passage height - 700 mm

PERFORMANCE

Max. panel weight with counterweight fire shutting ⁽³⁾	Single 1 x 200 kg Double 2 x 100 kg / 2 x 200 kg ⁽⁴⁾
Opening speed	Single : 10 to 80 cm/s - Double: 20 to 160 cm/s
Closing speed	Single : 10 to 80 cm/s - Double: 20 to 160 cm/s
Delay, remaining open	until 60 s
Opening force	5,5 to 15 daN
Closing force	5,5 to 15 daN

ELECTRICAL ENVIRONMENT

Universal power supply	50-60 HZ, 90-250 V ±10 % grounded power supply, bipolar insulation
Max. / avg. absorbed power	140 W / 55 W
Motor voltage / auxiliary power supply	40 Vcc / 15 Vcc (25 W)
Activated device of safety (DAS) control module	by transmission or break circuit 12 V / 24 V / 48 VDC
Backup battery	12 V (2,1 Ah)
Relative humidity level	10 % to 93 % without condensation
Operational temperature	- 20 °C / + 60 °C

STANDARDS

European directives	Electromagnetic compatibility: 2014/30/EU directive, machines: 2006/42/EC directive, radio: 2014/53/EU directive
EN 61000-6-3	EMC : emissions for residential, commercial and light industry environments
EN 61000-6-2	EMC : immunity for industrial environments
EN 60335-1/-2-103	Home appliance and analog device safety
EN 16005	Motorized door units for pedestrians : usage safety
EN 1634-1 / EN 13501-2	Fire resistance for construction products and elements
NFS 61937-1 and -3	Operated safety mechanisms

EQUIPMENT / CONTROLS / SAFETY / FINISHES

Activated device of safety (DAS) control module	●	Battery backup	●
Manual release	●	Autodoor Pilot smartphone app (Android / iOS)	●
Counterweight	●	NAVIBLU CAN dashboard	○
Electromechanical locking	○	Infrared NAVIBLU remote	○
Manual interior emergency unlocking	○	6-position key selector (with Reset)	○
Manual exterior unlocking (on fixed panel or jamb)	○	Input module (NO/NC/Frequency)	○
Radars (NO, NC, frequency)	○	Output module (2 relays)	○
Monitored safety curtains	○	RAL finish, anodized silver/color	●

● Series ○ Option



www.portalp.com

Siège social : PORTALP - 4 rue des Charpentiers - 95330 Domont - France



Certified Management System